

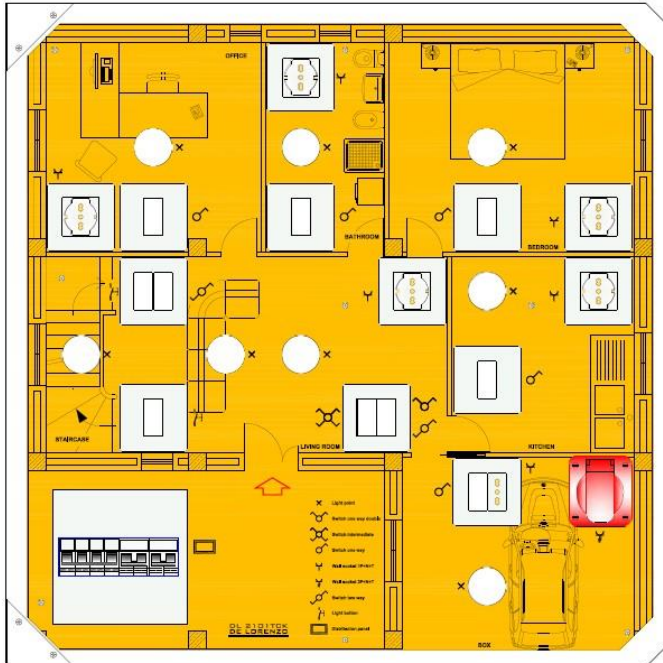

## RESIDENTIAL WIRING TRAINER KIT DL 2101TCK



With the residential wiring trainer kit, the students can study how to develop and cabling a typical residential electrical system.

It is made up of a panel that gives the floor plan of a house. The system is created using real components.

### DIDACTIC EXPERIENCE

- Single - point controlled lighting system
- Single point controlled lighting system with socket
- Switch-controlled two-lamps lighting system
- Two-point controlled lighting system
- Three-point controlled lighting system
- Four – point controlled lighting system
- Circuit breaking-relay controlled lighting system
- Switching-relay controlled

### COMPONENTS INCLUDED

- Three-phase autotransformer 400/24-42V
- 1 pc Tool Set
- 1 pc Shell wall IP30 8 modules
- 1 pc Circuit Breaker 4P 16A C 4.5 kA 552 665
- 1 pc Circuit Breaker 2P 16A C Ka 4.5
- 1 pc Circuit Breaker 2P 10A C Ka 4.5
- 50 m N07V-K 1 x 2.5 mm<sup>2</sup>, grey
- 50 m N07V-K 1 x 2.5 mm<sup>2</sup>, brown
- 50 m N07V-K 1 x 2.5 mm<sup>2</sup>, black
- 50 m N07V-K 1 x 2.5 mm<sup>2</sup>, blue
- 50 m N07V-K 1 x 2.5 mm<sup>2</sup>, green / yellow
- 13 pcs mounting box.
- 100 pcs cable clamps
- 10 m Corrugated PVC pipe
- 25 pcs Clips for pipe
- 4 pc 1P 10AX switch
- 1 pc 2P 10AX switch
- 2 pc 1P 10AX deviator
- 2 pc 1P 10AX reversing switch



## WORK BENCHES FOR ELECTRIC INSTALLATIONS



- 2 pcs pushbutton 1P NO 10 A, generic
- 7 pcs 1-module support
- 7 pcs Plate 1 module
- 5 pcs 2P + E 16A socket
- 1 pc 2P + T 16A B socket
- 5 pcs 2-module support
- 5 pcs Plate 2 modules
- 1 pcs pulse relay 24V ac
- 8 pcs Lamp holder E14
- 8 pcs E14 lamp 24V 25W
- 1 pc 3 phase socket 3P + N + T
- 10 pcs screw M4x16 wood